



DIMENSIONS (Cm)	Effective 105 x 120 x h.90
	On Pallet 105 x 120 x h.105
WEIGHT (Kg)	Effective 620
	On Pallet 635
OIL	SAE = 40
	Quantity = 14 lt.
ELECTRIC MOTOR	400V - 50HZ
	5,5 HP - 4 kW
RPM	6

	R. = 65 Kg. / mm ²			R. = 85 Kg. / mm ²		
Cutting capability	1 Ø 32	2 Ø 22	3 Ø 18	1 Ø 30	2 Ø 20	3 Ø 16
Bending capability	1 Ø 38	2 Ø 28	3 Ø 22	1 Ø 36	2 Ø 25	3 Ø 20

STANDARD EQUIPMENT

BLADES

On each cutting machine, 2 hardened steel blades are already fitted.

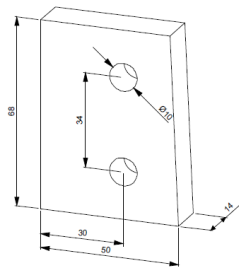

BIGGER ROTATING PLATE DIMENSION: Ø460 mm

It can support bushes up to Ø 260 mm to realize bending of big radius without need of extra equipments (Special Arm for large radii).



1 hardened square pin; 1 hardened stirrup bending pin;
3 hardened bush holding pins; 1 checking block; 1 pedal;
5 bushes Ø60-70-80-95-120 mm; 1 set Allen keys.
2 Long Saddles, indispensable to realize the "double bend"!

OPTIONALS



"UNIQUE 2 in 1"

To bend more stirrups simultaneously and determine the length from the bending point.



Spirals/Hoops Device:

Allows to realize spiral/hoop armatures with bars Ø max.16 mm.



"Basic Angle Control" Panel:

Allows to set up manually 6 bending angles, that will be carried out in sequence.



"Angle Control" Panel:

This special computer permits to program up to 20 bending angles in very rapid and intuitive way.



2-Speed Motor: Available on request for those who work bars of different diameters and want to optimize production times.



Special Bushes for large radii.



Working top "Type B": The cover in sheet metal prevents the turning plate from dust and material residuals.



Roller Bench:

To deposit and move the material. Available in different lengths, as needed.